

Stonetile  
the  
intelligent  
exterior  
choice





# UrbanStone UrbanStone UrbanStone



Barcelona



Vienna



Milan



Tokyo



New York



Mardi Gras

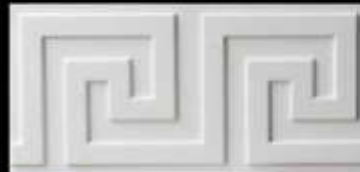

Athens



Buckingham



LaPalma



Mahal



Mykonos



Napa

UrbanStone, 3D Concrete Panels are produced with built-in Rainscreen. Bold and Beautiful!

UrbanStone is produced in Antique White color only. We recommend Sherwin Williams Loxon XP if other colors are required.

NEW PRODUCT

\$\$\$

Stonetile is the most  
ideal Exterior Product  
for North America's  
Woodframe Buildings!

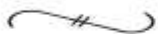

### **Only our Product can make all these claims**

1. Is mechanically fastened;
2. Has a 10 mm rainscreen airspace;
3. Has a CCMC number (12886-R);
4. May be installed in all kinds of weather;
5. Is priced lower than competitive products;
6. Line comprises of panels and moldings;
7. Is hail-proof;
8. Has a very small carbon footprint;
9. Does not need expansion joints;
10. Is guaranteed for 25 Years;
11. Stonetile has been in operation since 1988;

### **Stonetile has 12 benefits:**

1. Mechanically fastened stone products cannot fall off the walls, (no mortar failures).
2. Rainscreen prevents moisture from getting into the walls, preventing mold and rot.
3. Only products which have been extensively engineer tested receive CCMC approval.
4. Concretes made of real crushed stone, not of lightweight materials last longer (much denser).
5. Stonetile can be installed in all weather without heated hording, saving money,
6. Our reasonable prices provide savings when compared to other products.
7. Designer options with, so much to choose from (stone panels and moldings).
8. Stonetile withstands devastating hailstorms without any damage reported.
9. We use local material in our product, saving Trees. Our products contain no plastics.
10. Unsightly expansion joints are not needed with our product (patented technology).
11. Our 25-year product warranty will give you peace of mind.
12. We are looking forward to our next 30 years of customer service.



# Introducing LedgeStone



LedgeStone  
is produced  
in these sizes.

**\$\$ NEW PRODUCT**

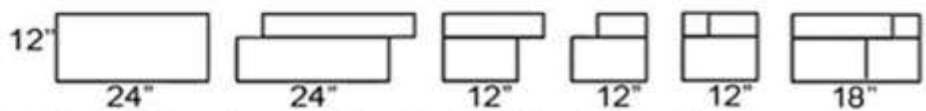

LedgeStone is approximately 1" thick + 10mm Air space



# Introducing Summit Stone

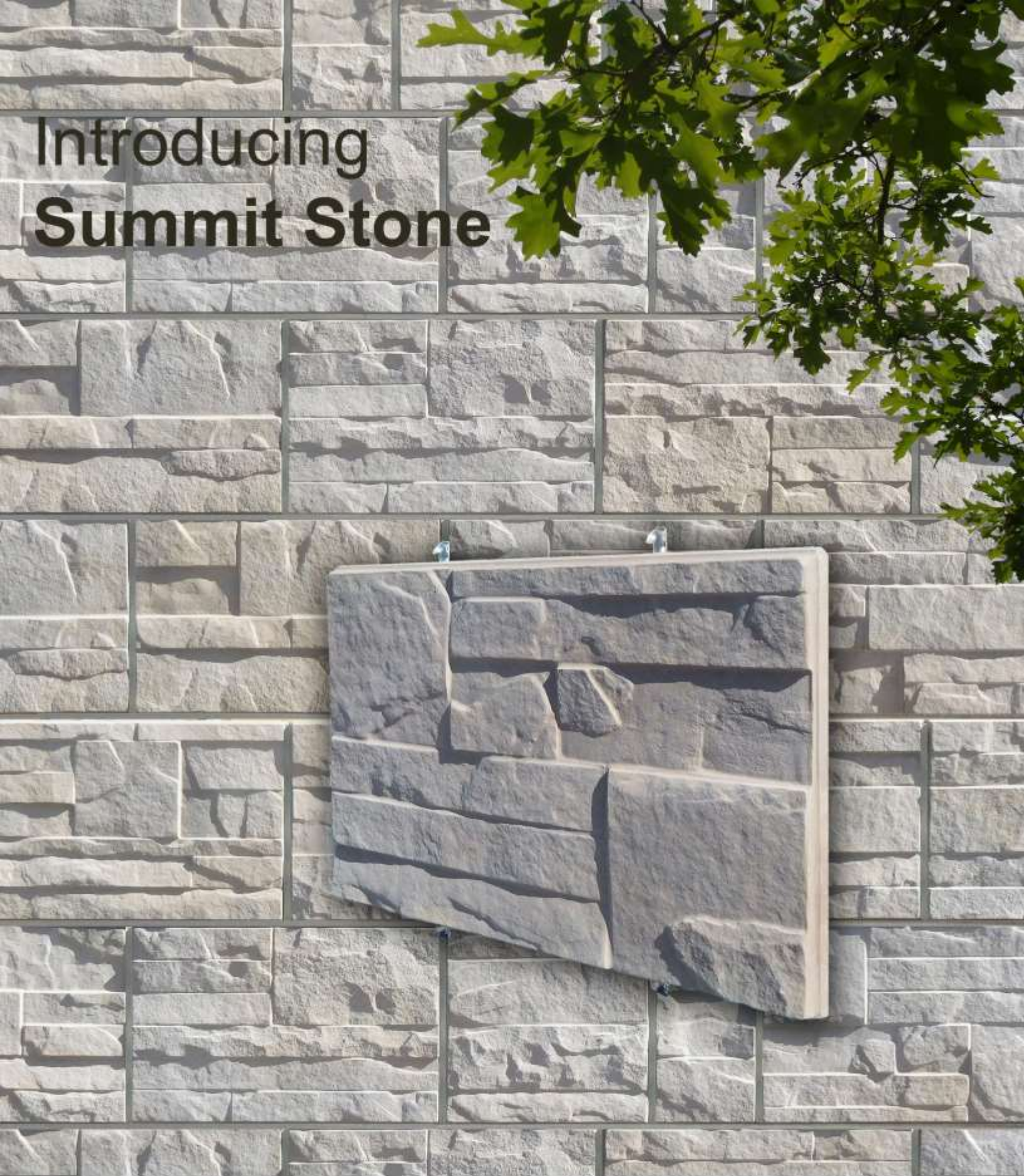

Summit Stone  
is produced in  
these sizes.

**\$\$ NEW PRODUCT**



9"



12"

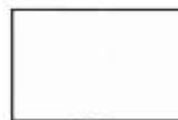

18"

SummitStone is approximately 1" thick + 10mm Airspace

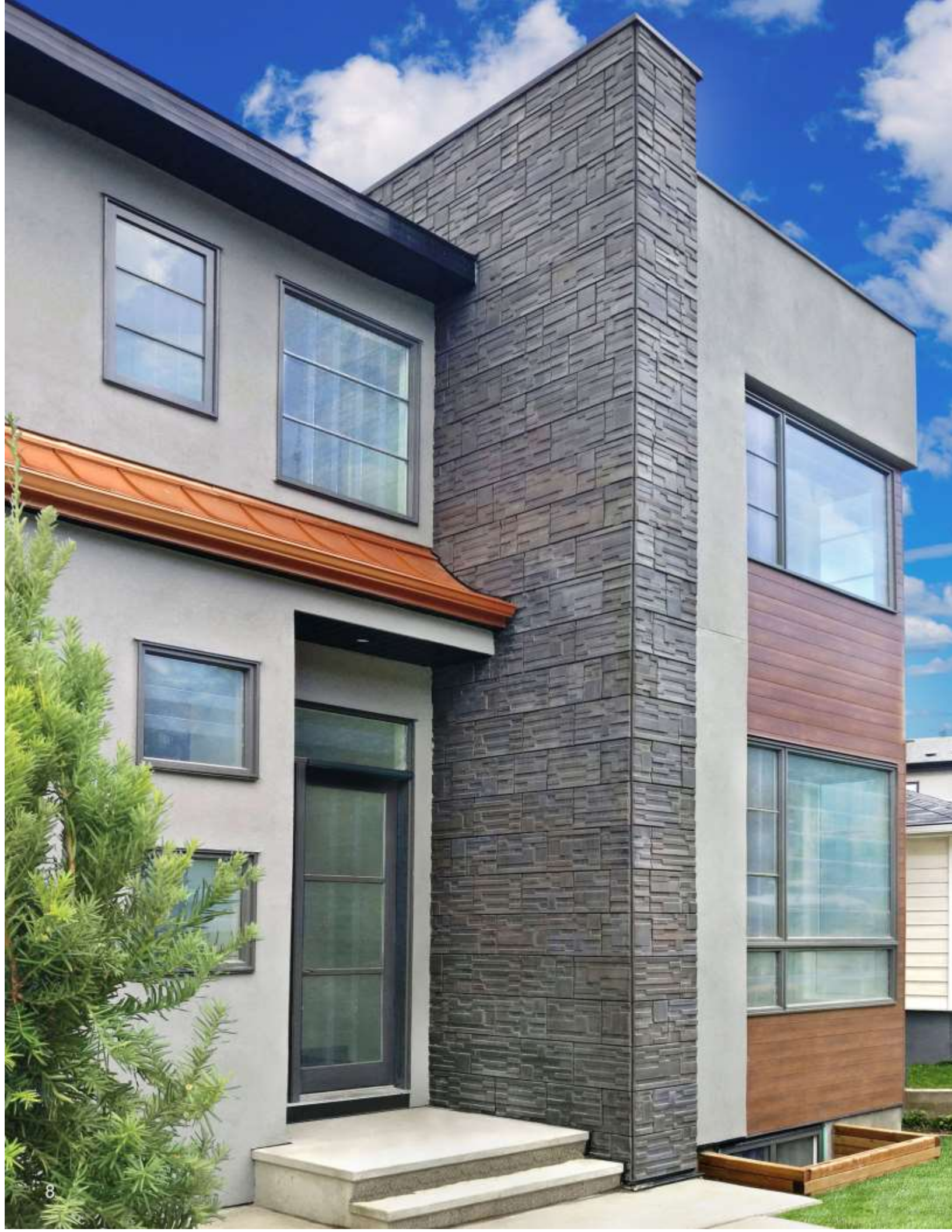



# Introducing AstroStone



AstroStone  
is produced  
in these sizes.

\$\$ **NEW PRODUCT**



AstroStone is approximately 1" thick +10 mm Airspace



# Presenting Brick Tile



Brick Tile  
is produced  
in these sizes.

**\$\$ NEW PRODUCT**

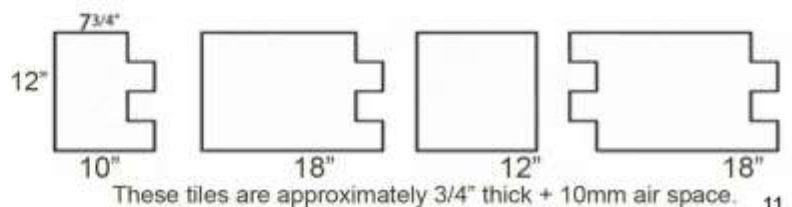



# MetroStone

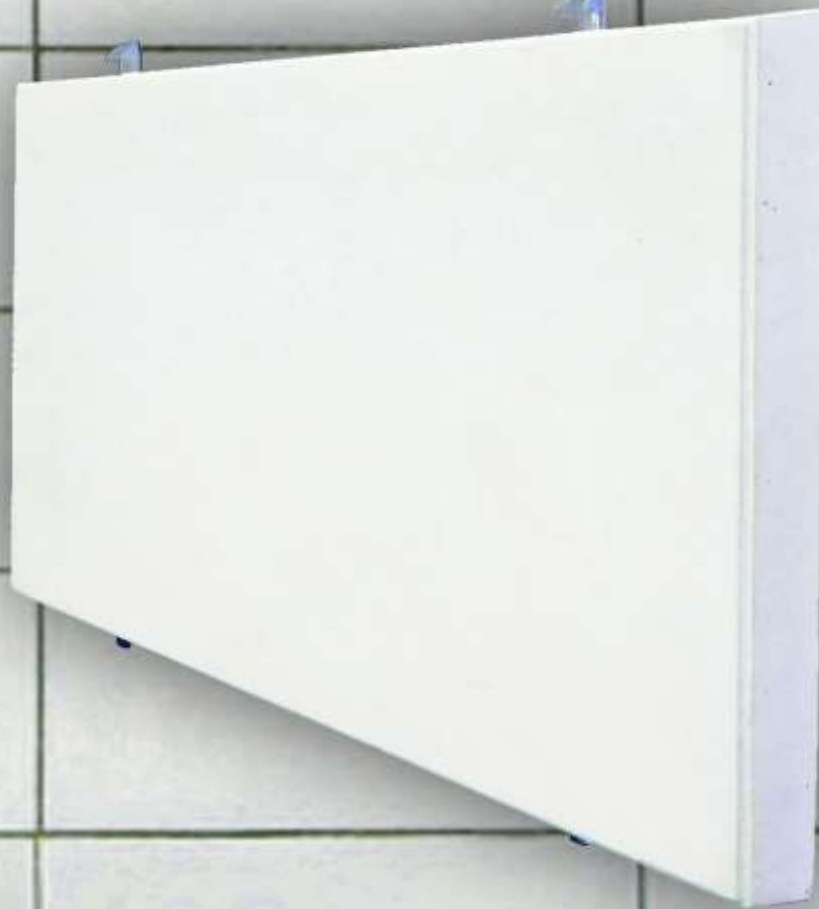

MetroStone is produced in these sizes,

**\$\$ NEW PRODUCT**



MetroStone is approximately 1" thick + 10mm Air space



# Bevel Tile



Bevel Tile is produced in these sizes

\$\$

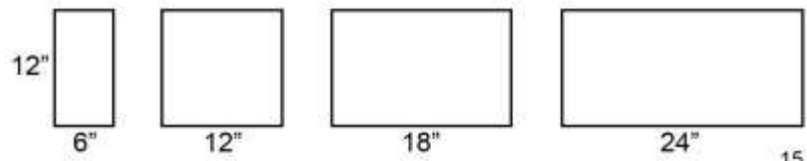



84



# Slate Tile



Slate Tile is produced in these Sizes.

12"



6"



12"



18"



24"

Slate Tiles are approximately 3/4" thick + 10mm Airspace



# Rustic Tile

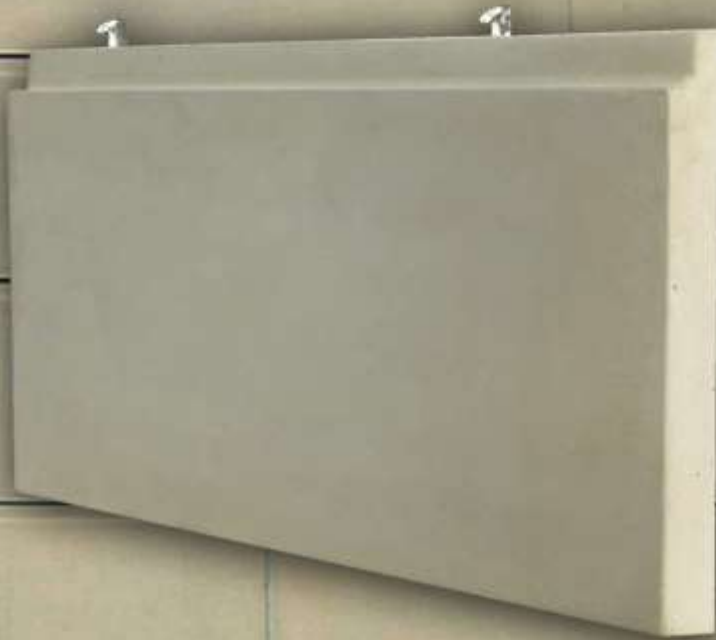

Rustic Tile is produced in these Sizes.

\$\$

12"

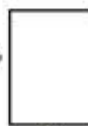

9"



18"



36"

Rustic Tiles are approximately 1" thick + 10mm Airspace<sub>19</sub>



# Heritage Tile



Heritage Stone is produced in these sizes.

Note: Using a combination of varying sizes produces a natural aesthetics.

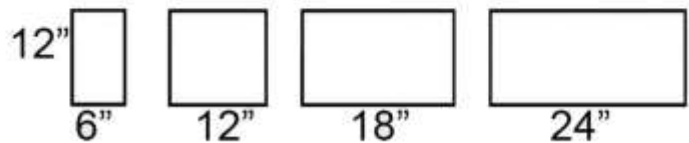

Heritage Tile is approximately 1" thick + 10mm Airspace



# CaboStone



\$\$

CaboStone is produced in these sizes.

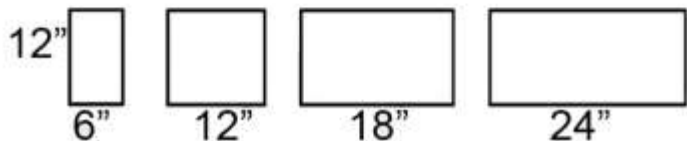

CaboStone is approximately 1" thick + 10mm Airspace



**Stonetile,  
the only  
Concrete  
Molding  
Product  
with a  
built-in  
Rainscreen  
Airspace.**

Stonetile offers a full line of beautiful moldings which are also mechanically fastened. Ask us for our detailed catalog. There is so much to choose from.

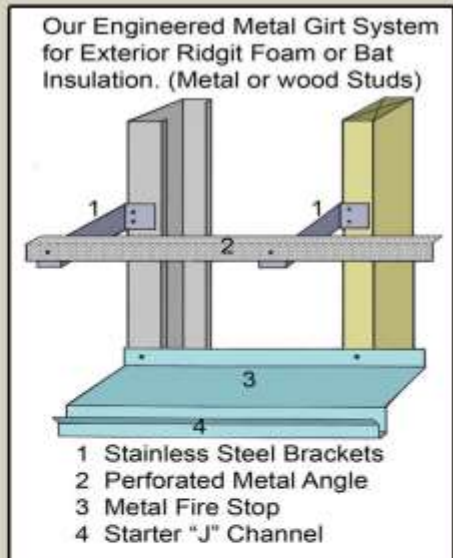

**Quirk  
Corners.**

Stonetile utilises Quirk corners. These type of corners have been in use by craftsmen for many centuries. This method prevents butt joints when moldings are part of the design. It also prevents notorious corner breakage.

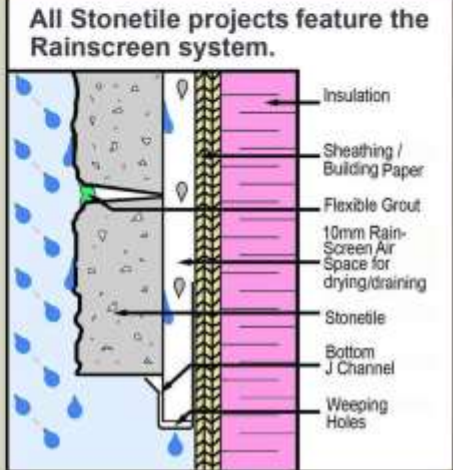

\$ Indicates Pricepoint A  
 \$\$ Indicates Pricepoint B  
 \$\$\$ Indicates Pricepoint C

**Our 8 Standard Colors**



Stonetile (Canada) Ltd.  
 4055-96 Ave. SE  
 Calgary, Alberta  
 T2C 4T7

Ph: 403 279-2214  
 Fax: 403 236-8979  
 Ph: 800 266-9320  
 Email: foralifetime@stonetile.com  
 www.stonetile.com